

B ENLARGED BASEMENT PLAN
1/8"=1'-0"
NORTH

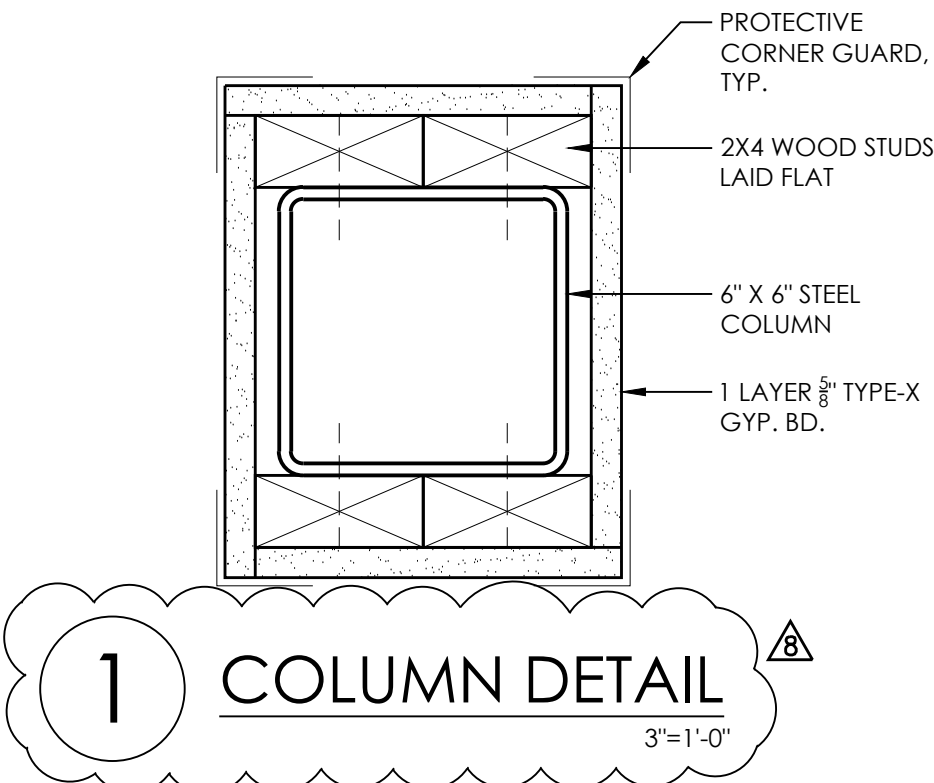

1 COLUMN DETAIL
3"=1'-0"
NORTH

ROWING EQUIPMENT SCHEDULE

	SHOWN		SHOWN		
1	CHARGING STATION	●	21	12 SCULLING OARS, SETS OF 2	●
2	CORK BOARD	●	22	(2) FLAMMABLE CABINET	●
3	MARKER BOARD	●	23	DRILL PRESS	●
4	TV/ DVD WALL HUNG	●	24	REFRIGERATOR BY TENANT	▲
5	(4) YELLOW CABINETS	●	25	(20) SETS OF 2 SHELL SLINGS	●
6	WORK TABLE	●	26	(12) SETS OF 2 SHELLS TS	●
7	GRAY SMALL PART CABINET	●	27	UTILITY SINK	●
8	TAN SHELVES	●	28	HAND SINK W/ DRINKING WATER SPOUT	●
9	BIG RED TOOL BOX	●	29	FOLDING TABLES	●
10	BLACK 2 DOOR CABINET	●	30	STORAGE TUBS	●
11	GREY METAL WORK DESK	●	31	BOX STEPS	●
12	(3) 4 DRAWER FILING CABINET	●	32	(74) 12X12X24 LOCKERS	●
13	2 DRAWER FILING CABINET	●	33	(2) TABLE DOLLEYS	●
14	LIQUIDS CABINET	●	34	ELECTRIC WATER FOUNTAIN	●
15	METAL SHELF	●	35	HOSE REEL	●
16	(2) STACKED GRAY DRAWER UNITS	●	36	(500) JET FLOAT SQUARES	●
17	BLUE METAL DRAWER UNIT	●	37	(1) LOCKSTAY RACK	●
18	AIR COMPRESSOR	●	38	(3) A FRAME SET	●
19	WASHER/ DRYER	●	39	(2) METAL ROLLING RACKS	●
20	12 SWEEP OARS, SETS OF 10	●	40	(5) COACHING LAUNCHES	●

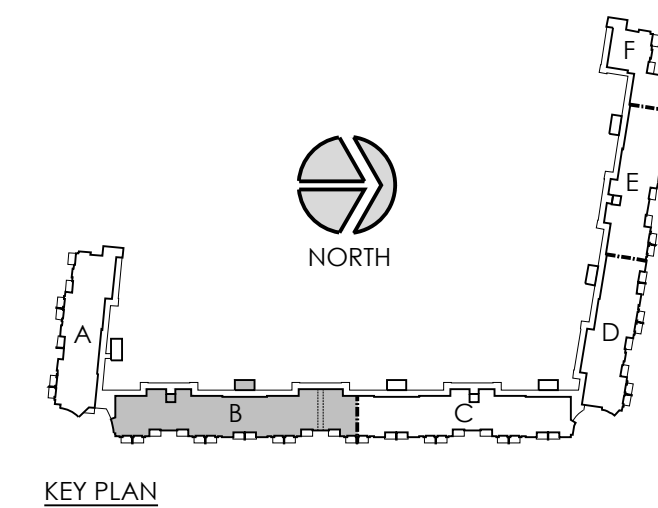

DATE DRAWN
12-10-15

REVISIONS

- ▲ 05-09-16 GENERAL REVISIONS
- ▲ 05-25-16 GENERAL REVISIONS
- ▲ 07-14-16 VE
- ▲ 10-25-16 LEASING OFFICE REV

PRINTS ISSUED

- 12-16-15 OWNER REVIEW
- 01-13-16 OWNER REVIEW
- 01-27-16 DD SET
- 02-11-16 60% SET
- 03-03-16 90% COORDINATION
- 03-25-16 PERMIT SET
- 05-09-16 CITY RESUBMISSION
- 05-25-16 CITY RESUBMISSION
- 07-14-16 FOR CONSTRUCTION
- 08-22-16 VE SET #1
- 10-25-16 LEASING OFFICE REV
- 11-16-16 LEASING OFFICE REV

KREHBIEL ARCHITECTURE

1300 E. Lewis
Wichita KS 67211
316.247.8233
316.247.8566 fax
krehbielarchitecture.co

DATE
11-16-16
KANSAS ARCHITECT

RIVER VISTA APARTMENTS
150 N. McLean Blvd.
WICHITA, KANSAS

PROJECT NO.
15052

SHEET TITLE
BASEMENT FLOOR PLANS
EQUIPMENT SCHEDULE

SHEET NO.
A1.0

© Copyright 2016 Krehbiel Architecture

N:\15052\15052_A1.0_Basement Plan-B.dwg, 24x36, 11/17/2016 2:12:42 PM, shageman

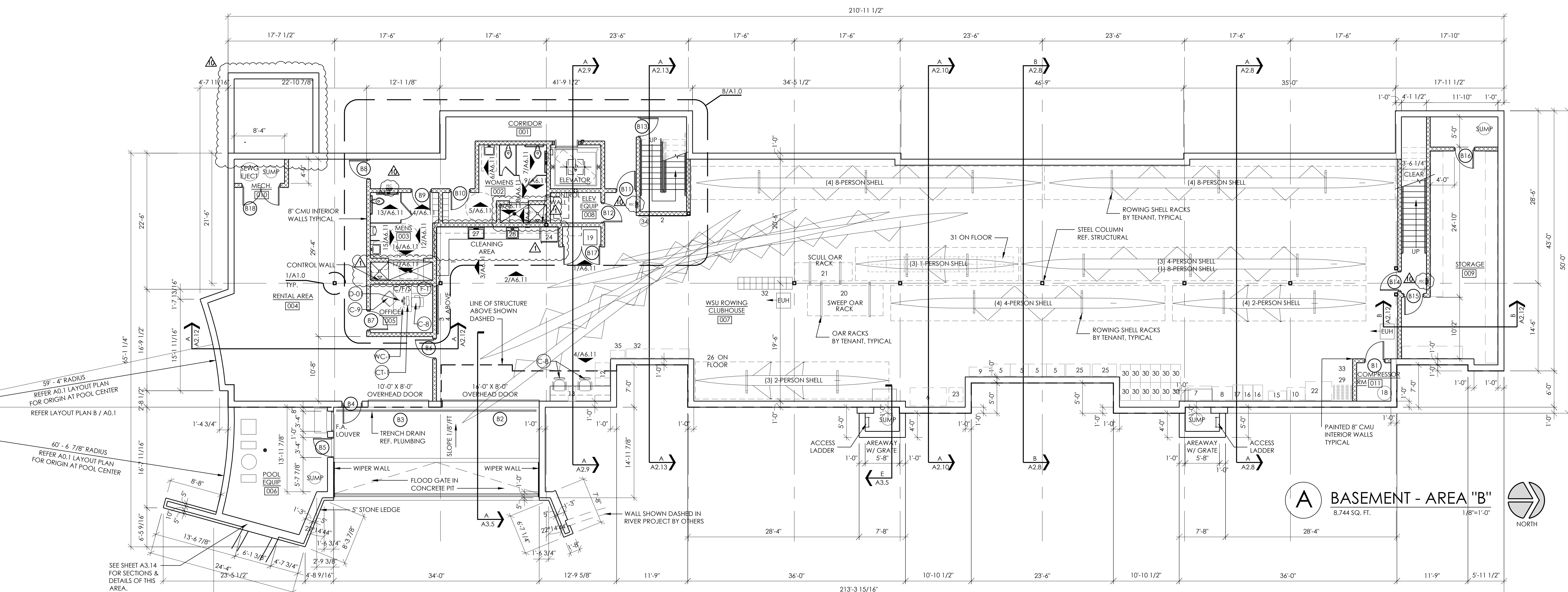

A BASEMENT - AREA "B"
8,744 SQ. FT.
1/8"=1'-0"
NORTH

59' - 4" RADIUS
REFER A0.1 LAYOUT PLAN
FOR ORIGIN AT POOL CENTER

60' - 6 7/8" RADIUS
REFER A0.1 LAYOUT PLAN
FOR ORIGIN AT POOL CENTER

SEE SHEET A3.14
FOR SECTIONS &
DETAILS OF THIS
AREA.